

Foodservice Equipment • Material Handling, Healthcare & Cleanroom Equipment • Retail Display

412 Series Sinks

Deep-Drawn Coved Corner
One-, Two-, and Three-Compartment



Item #: _____
 Model #: _____
 Project #: _____
 SIS #: _____

Optional Accessories	Model #	Qty.
Stainless steel legs		
Stainless steel bullet feet		
White metal bullet feet		
Lever drains		
Twist handle drains		
Faucets		
Sink covers		
Waste outlet		
Sink kits		
Twist drain brackets		
Overflow hole		



- All heavy gauge type 430 construction — bowls and top assembly.
- Deep-drawn seamless coved corner bowls.
- Legs are braced front-to-back.
- Swirl-away drainage.
- Legs welded adjacent to sink bowls for maximum weight support and stability.
- 9½" (241mm) standard backsplash includes 1" (25mm) upturn and tile edge for easy installation and feathering to wall/splash surfaces.
- Die-stamped creased drainboards for positive drainage.

Sink Kits for 412 Series Sinks

Kits include stainless steel crossbraced legs, stainless steel gussets and stainless steel feet as listed below.

Kit A

description	add suffix
Includes crossbraced legs, gussets, feet, and T&S faucet*	"-CLF"

Kit B

description	add suffix
Includes crossbraced legs, gussets, feet, T&S faucet*, and lever drain	"-CLFD"

Kit C

description	add suffix
Includes crossbraced legs, gussets, feet, T&S faucet*, and lever drain with overflow	"-CLFDO"

* T&S faucet #313293

Spec sheets available for viewing, printing or downloading from our online literature library at www.eaglegrp.com

412 Series Coved Corner Sinks

NSF-approved installations:

All EAGLE sinks bearing the NSF Certification Mark are built in compliance with the National Sanitation Foundation Standard Number 2. EAGLE is also listed to manufacture custom-built sinks in compliance with the National Sanitation Foundation Standard Number 2.

Material:

- Sink Bowls** – Heavy gauge type 430 stainless steel.
- Top** – Drainboards, backsplash and rolled rims are heavy gauge type 430 stainless steel.
- Legs** – 1½" (41mm)-diameter heavy-gauge galvanized tubing with plated 12-gauge gussets and high-impact corrosion resistant fully adjustable bullet feet - crossbracing is 1" (25mm)-diameter heavy-gauge galvanized tubing.

Design and Construction Features:

- All bowls have deep-drawn one-piece seamless construction, using state-of-the-art hydraulic presses.
- Drainboards, when provided, are integrally welded.
- All sink bowls have a generous radius with a minimum dimension of 3" (76mm) and are rectangular for maximum capacity.
- Leg locations are adjacent to sink bowls, providing increased stability and maximum weight support where needed.
- Leg gussets are welded to a die-cut heavy gauge reinforcing plate.
- Legs are braced front-to-back for added rigidity.
- Entire assembly is fuse-welded and planished, providing a one-piece seamless sink unit.
- 9½" (241mm)-high full length standard backsplash features 1" (25mm) upturn and tile edge for easy installation and feathering to wall/splash surface.
- Welded areas are high-speed belt blended to match adjacent surfaces with continuity of satin finish.
- All outside corners of sink assembly are bullnosed to provide safe, clean edges.
- 10½" (267mm) water level — 13½" (343mm) flood level.

Mechanical:

- Water supply is ½" (13mm) IPS for hot and cold lines.
- Faucet holes are 1½" (29mm) punched on 8" (203mm) centers.
- Faucets are available as options.
- Basket-type waste drains included fit sink bowls' 3½" (89mm) opening and feature 1½" (38mm) outlet.

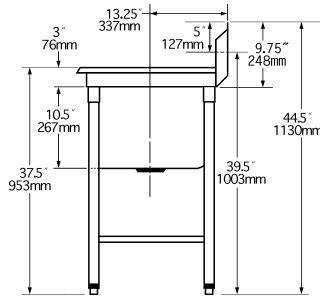

Sinks with One Compartment

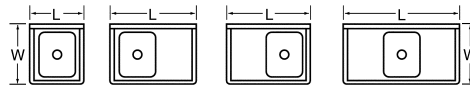

bowl size width x length	number of drainbds	drainbd length		weight		overall size width x length		model #
		in.	mm	lbs.	kg	in.	mm	
19" x 16" (483 x 406mm)	0	n/a		40	18.1	26" x 21½"	660 x 546	412-16-1
	1	18"	457	59	26.8	26" x 37¼"	660 x 959	412-16-1-18R or L
	2	18"	457	78	35.4	26" x 54"	660 x 1372	412-16-1-18
	1	24"	610	65	29.5	26" x 43¾"	660 x 1111	412-16-1-24R or L
	2	24"	610	90	40.8	26" x 66"	660 x 1676	412-16-1-24
	1	30"	762	70	31.8	26" x 49¾"	660 x 1264	412-16-1-30R or L
	2	30"	762	100	45.4	26" x 78"	660 x 1981	412-16-1-30
	1	36"	914	75	34.0	26" x 55¾"	660 x 1416	412-16-1-36R or L
2	36"	914	110	49.9	26" x 90"	660 x 2286	412-16-1-36	

Sinks with Two Compartments

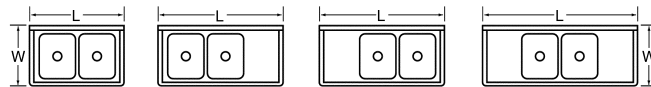

bowl size width x length	number of drainbds	drainbd length		weight		overall size width x length		model #
		in.	mm	lbs.	kg	in.	mm	
19" x 16" (483 x 406mm)	0	n/a		64	29.0	26" x 39"	660 x 991	412-16-2
	1	18"	457	83	37.6	26" x 55½"	660 x 1410	412-16-2-18R or L
	2	18"	457	102	46.3	26" x 72"	660 x 1829	412-16-2-18
	1	24"	610	89	40.4	26" x 61½"	660 x 1562	412-16-2-24R or L
	2	24"	610	114	51.7	26" x 84"	660 x 2134	412-16-2-24
	1	30"	762	94	42.6	26" x 67½"	660 x 1714	412-16-2-30R or L
	2	30"	762	124	56.2	26" x 96"	660 x 2438	412-16-2-30
	1	36"	914	99	44.9	26" x 73½"	660 x 1867	412-16-2-36R or L
2	36"	914	134	60.8	26" x 108"	660 x 2743	412-16-2-36	

Sinks with Three Compartments

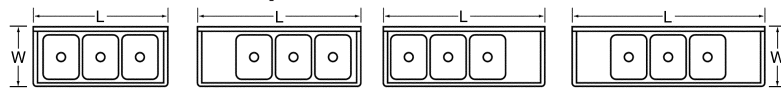

bowl size width x length	number of drainbds	drainbd length		weight		overall size width x length		model #
		in.	mm	lbs.	kg	in.	mm	
19" x 16" (483 x 406mm)	0	n/a		85	38.6	26" x 57"	660 x 1448	412-16-3
	1	18"	457	104	47.2	26" x 73½"	660 x 1867	412-16-3-18R or L
	2	18"	457	123	55.8	26" x 90"	660 x 2286	412-16-3-18
	1	24"	610	110	49.9	26" x 79½"	660 x 2019	412-16-3-24R or L
	2	24"	610	135	61.2	26" x 102"	660 x 2591	412-16-3-24
	1	30"	762	115	52.2	26" x 85½"	660 x 2172	412-16-3-30R or L
	2	30"	762	145	65.8	26" x 114"	660 x 2896	412-16-3-30
	1	36"	914	120	54.4	26" x 91½"	660 x 2324	412-16-3-36R or L
2	36"	914	155	70.3	26" x 126"	660 x 3200	412-16-3-36	