

Project \_\_\_\_\_  
 Item \_\_\_\_\_  
 Quantity \_\_\_\_\_  
 CSI Section 11400  
 Approved \_\_\_\_\_  
 Date \_\_\_\_\_

# GARFF1 P-D Fish File

Specification Line® Refrigerated fish file with drawers

## Models

☐ GARFF1P-D



GARFF1P-D

## Standard Features

- easyTouch Control with remote monitoring capability
- Digital exterior temperature display with high/low temp visual alarms
- Removable side louver
- Accommodates full size sheet pans
- Energy efficient drawer gasket – removable without tools
- 5" locking casters shipped loose for field installation
- 10' cord and plug attached
- Stainless steel exterior front, sides & interior
- 115V / 60C / 1 P Standard
- Three year parts and labor warranty and an additional 2 year compressor parts warranty.

## Options & Accessories

- 6" Stainless steel feet
- 6" Casters (all locking)
- 6" Stainless Steel flanged feet
- Utility base
- Kick plate
- Laminate – front, ends, shroud
- Heat shield end – max temp 400 degrees
- Trim strips

## Specifications

**Refrigeration system:** All components are mounted to the top cabinet ceiling, outside the food zone and are assembled as one piece and can be removed as one piece. Environmentally friendly R290 refrigerant is used. System has the capability of maintaining between 33°F and 40°F in heavy use food service operations. Refrigerant is metered using a highly responsive thermostatic expansion valve. System is controlled using an electronic temperature control, which provides improved pull down times, reducing compressor cycling and longer compressor life with lower energy consumption. Control system uses adaptive defrost to assure evaporator coil is free of ice and operating at optimum efficiency. Evaporator condensate is eliminated using an energy efficient hot gas system.

Units are completely insulated with high density foamed in place environmentally friendly, Kyoto Protocol Compliant, Non ODP (Ozone Depletion Potential), Non GWP (Global Warming Potential) polyurethane.



# GARFF1P-D Fish File

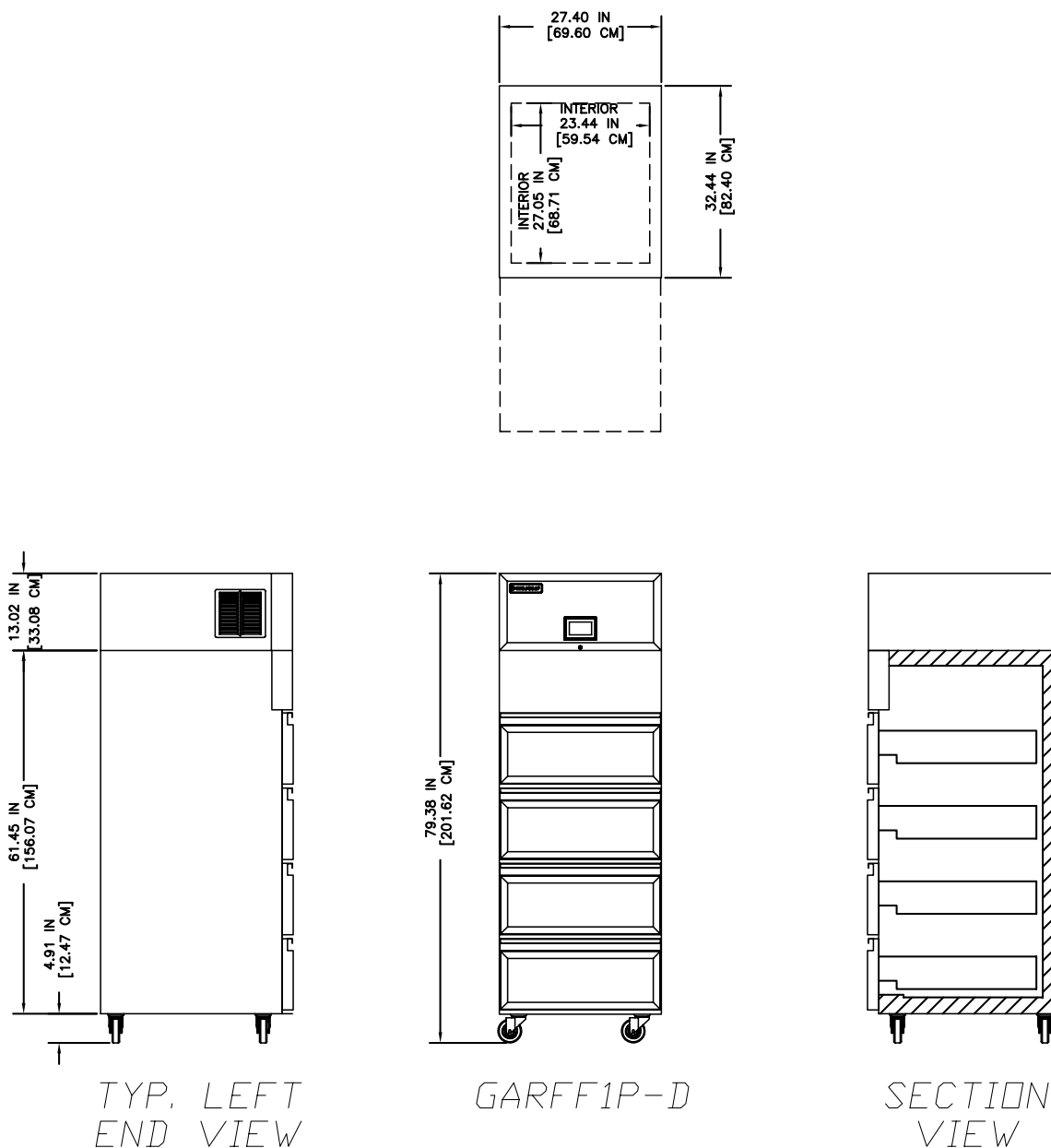

Specifications							
Model	V/Hz/Ph	Amps	Volume Cu. Ft.	Unit H.P.	Btu/Hr System Cap	Ship Weight	Nema Plug
GARFF1P-D	115/60/1	6.0	24.96	1/4	2092	418 lbs (190 kg)	5-15 P

Welbilt reserves the right to make changes to the design or specifications without prior notice.