



PROJECT	
ITEM #	
QUANTITY	DATE
APPROVAL	

## KC & KC-NU

### Mobile All-Purpose Counters

#### Short Form Specifications

**Exterior body** is seamless, one-piece molded fiberglass, having perfectly smooth exterior surfaces and corners fully rounded. The fiberglass reinforced polyester (F.R.P.) is molded with permanent color. Stress points are internally reinforced.

**Exterior top** is constructed of 14-gauge stainless steel, welded, ground and polished into one integral unit. Top is fabricated with square exterior corners.

**Casters** unit is mounted on 5" (12.7cm) diameter swivel casters with non-marking polyolefin tires and plate brakes. Overall height of caster assembly is 6" (15.2cm).

#### The following applies to KC Series only

KC units have a two door dry compartment(s) constructed of 18-gauge stainless steel. Each compartment is equipped with a stainless steel shelf; doors are double-wall construction, with stainless steel front panel.

- KC-28, one compartment, 18" wide with one door
- KC-36, one compartment, 24" wide with one door
- KC-50, one compartment, 36" wide with two doors
- KC-60, one compartment, 48" wide with two doors
- KC-74, one compartment, 48" wide with two doors
- KC-96, two compartments, each 36" wide with two doors each

#### Optional Accessories and Modifications

- A) 12" (30.5cm) wide stainless steel fold-down tray slide
- C) 10" (25.4cm) wide three-bar fold-down tray slide
- D) 10" (25.4cm) wide composite fold-down cutting boards
- E) 10" (25.4cm) wide stainless steel fold-down work shelf
- F) Line-up interlock device
- F1) Fiberglass door panel insert (KC only)
- G) Glass-front counter protector
- H) Two tier display with glass shelves and sneezeguards
- HD) Dual service two tier display with sneezeguards
- I) Three tier display with glass shelves and sneezeguards
- J) 12" (30.5cm) wide 18-gauge stainless steel overshef
- KS) Single service flip-up sneezeguard
- KD) Double service flip-up sneezeguard
- L) \*Fluorescent or incandescent light fixtures (specify which)
- M) \*Radiant heat lamps
- MB) \*Bullet-style heat lamps
- P) Open understorage with shelf (KH-NU Series only)
- Q) \*120V/60Hz/1Ø, 10 amp convenience outlet with breaker
- SG5A) Single dry insert with doors (KC-NU only)
- SG5B) Double dry insert with doors (KC-NU only)
- ST) Stainless steel trim strips
- UU) Molded fiberglass trim strips
- U) 14 x 30" (35.6cm x 76.2cm) stainless steel end drop shelf
- V) 6" (15.2cm) high adjustable stainless steel legs in lieu of casters



**Model KC-50**  
shown with options A, F, and G

*Inclusion of these options will alter the electrical specifications of unit.*



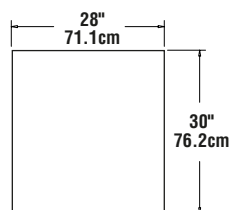

**PLAN VIEW**  
**KC-28/**  
**KC-28-NU**

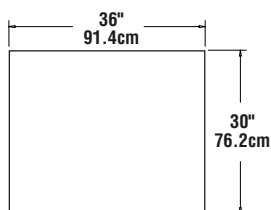

**PLAN VIEW**  
**KC-36/**  
**KC-36-NU**

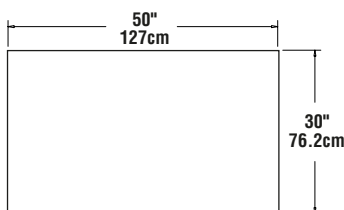

**PLAN VIEW**  
**KC-50/**  
**KC-50-NU**

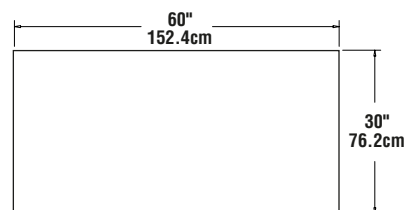

**PLAN VIEW**  
**KC-60/**  
**KC-60-NU**

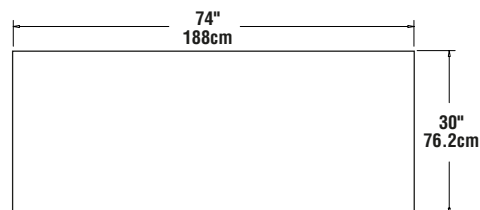

**PLAN VIEW**  
**KC-74/**  
**KC-74-NU**

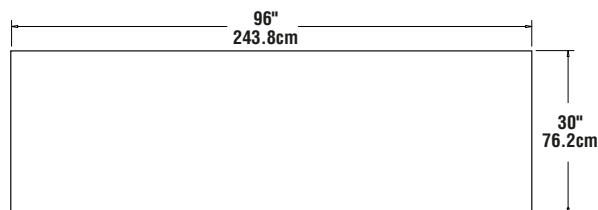

**PLAN VIEW**  
**KC-96/**  
**KC-96-NU**

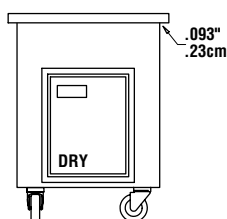

**ELEVATION VIEW**  
**KC-28 AND**  
**KC-36**

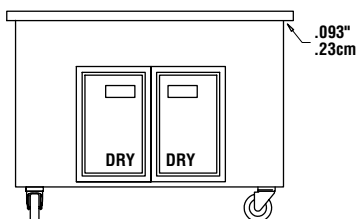

**ELEVATION VIEW**  
**KC-50 THROUGH**  
**KC-74**

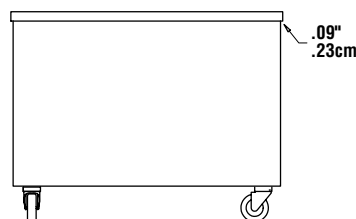

**ELEVATION VIEW**  
**ALL KC-NU MODELS**

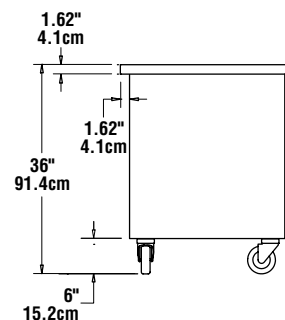

**END VIEW**  
**ALL MODELS**

### Mechanical Data—Standard Unit

MODEL NUMBER	# OF DOORS	# OF SHELVES	SHIP WEIGHT	MODEL NUMBER	SHIP WEIGHT
<b>KC-28</b>	1	1	165 lbs/75 kg	<b>KC-28-NU</b>	120 lbs/54 kg
<b>KC-36</b>	1	1	185 lbs/84 kg	<b>KC-36-NU</b>	160 lbs/73 kg
<b>KC-50</b>	2	1	205 lbs/93 kg	<b>KC-50-NU</b>	180 lbs/82 kg
<b>KC-60</b>	2	1	240 lbs/109 kg	<b>KC-60-NU</b>	210 lbs/95 kg
<b>KC-74</b>	2	1	270 lbs/123 kg	<b>KC-74-NU</b>	240 lbs/109 kg
<b>KC-96</b>	4	2	310 lbs/141 kg	<b>KC-96-NU</b>	280 lbs/127 kg