

PROJECT	
ITEM #	
QUANTITY	DATE
APPROVAL	

SC & SC-NU

Mobile All Purpose Counters

Short Form Specifications

Exterior body is constructed of 18-gauge stainless steel side panels and 14-gauge galvanized bottom. All exterior side panels are reinforced with overlapping corners and are welded in place. All body cutouts are reinforced with 14-gauge galvanized channel supports.

Exterior top is constructed of 14-gauge stainless steel, welded, ground and polished into one integral unit. Top is fabricated with square exterior corners.

Casters unit is mounted on 5" (12.7cm) diameter swivel casters with non-marking polyolefin tires and plate brakes. Overall height of caster assembly is 6" (15.2cm).

The following applies to SC Series only

SC units have a one or two door dry compartment(s) constructed of 18-gauge stainless steel. Each compartment is equipped with stainless steel shelf; door(s) are double-wall construction, with stainless steel front panel.

- SC-28, one compartment, 18" wide with one door
- SC-36, one compartment, 24" wide with one door
- SC-50, one compartment, 36" wide with two doors
- SC-60, one compartment, 48" wide with two doors
- SC-74, one compartment, 48" wide with two doors
- SC-96, two compartments, each 36" wide with two doors each

Optional Accessories and Modifications

- A) 12" (30.5cm) wide stainless steel fold-down tray slide
- C) 9" (22.9cm) wide three-bar fold-down tray slide
- D) 10" (25.4cm) wide composite fold-down cutting boards
- E) 10" (25.4cm) wide stainless steel fold-down work shelf
- F) Line-up interlock device
- G) Glass-front counter protector
- H) Two tier display with glass shelves and sneezeguards
- HD) Dual service two tier display with sneezeguards
- I) Three tier display with glass shelves and sneezeguards
- J) 12" (30.5cm) wide 18-gauge stainless steel overself
- KS) Single service flip-up sneezeguard
- KD) Double service flip-up sneezeguard
- L) *Fluorescent or incandescent light fixtures (specify which)
- M) *Radiant heat lamps
- MB) *Bullet-style heat lamps
- P) Open understorage with shelf (SC-NU Series only)
- Q) *120V/60Hz/1ø, 10 amp convenience outlet with breaker
- SG5A) Single dry insert with doors (SC-NU Series only)
- SG5B) Double dry insert with doors (SC-NU Series only)
- ST) Stainless steel trim strips
- U) 14" x 30" (35.6cm x 76.2cm) stainless steel end drop shelf
- V) 6" (15.2cm) high adjustable stainless steel legs in lieu of casters

**Inclusion of these options will alter the electrical specifications of unit.*



Model SC-36-NU

shown with options A, F, G and P



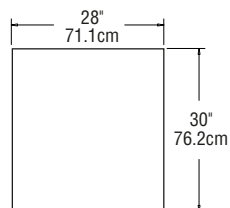

PLAN VIEW
SC-28/
SC-28-NU

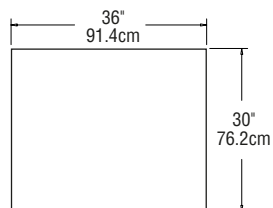

PLAN VIEW
SC-36/
SC-36-NU

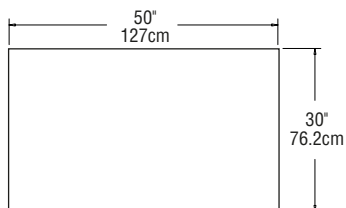

PLAN VIEW
SC-50/
SC-50-NU

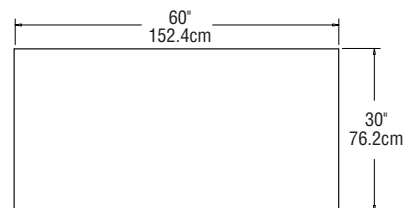

PLAN VIEW
SC-60/
SC-60-NU

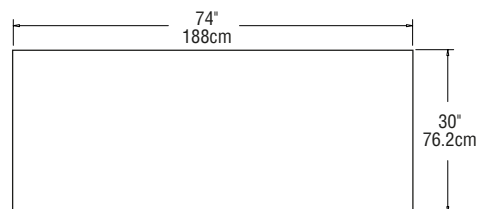

PLAN VIEW
SC-74/
SC-74-NU

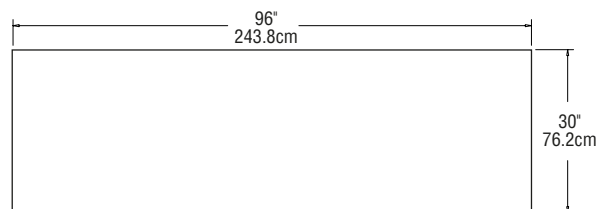

PLAN VIEW
SC-96/
SC-96-NU

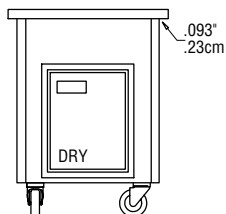

ELEVATION VIEW
SC-28 AND
SC-36

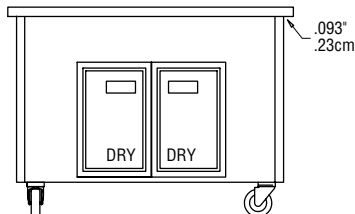

ELEVATION VIEW
SC-50 THROUGH SC-96
(two compartments on
SC-96 - not shown)

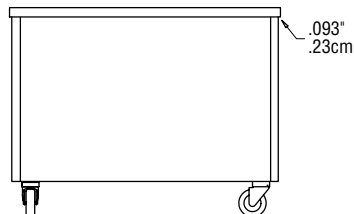

ELEVATION VIEW
ALL SC-NU MODELS

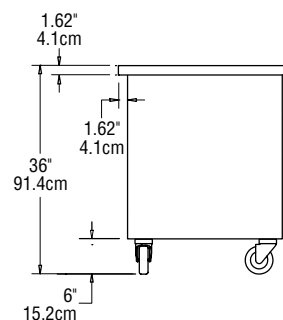

END VIEW
ALL MODELS

Mechanical Data—Standard Unit

MODEL NUMBER	# OF DOORS	# OF SHELVES	SHIP WEIGHT	MODEL NUMBER	SHIP WEIGHT
SC-28	1	1	165 lbs/75 kg	SC-28-NU	120 lbs/54 kg
SC-36	1	1	185 lbs/84 kg	SC-36-NU	160 lbs/73 kg
SC-50	2	1	205 lbs/93 kg	SC-50-NU	180 lbs/82 kg
SC-60	2	1	240 lbs/109 kg	SC-60-NU	210 lbs/95 kg
SC-74	2	1	270 lbs/123 kg	SC-74-NU	240 lbs/109 kg
SC-96	4	2	310 lbs/141 kg	SC-96-NU	280 lbs/127 kg