

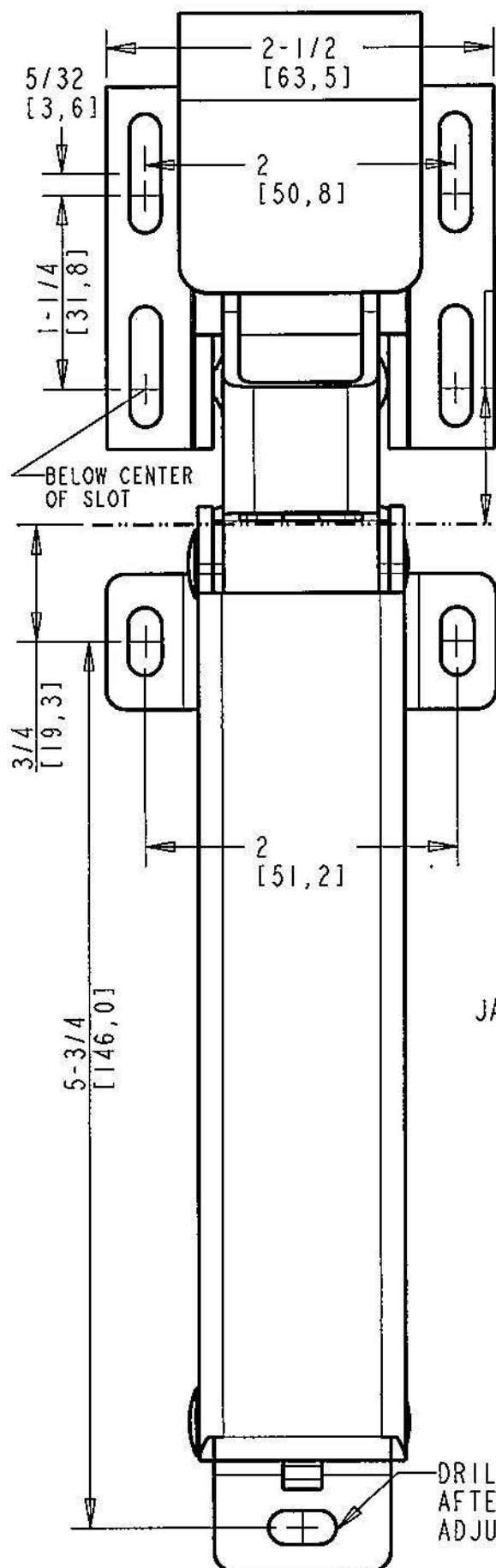

1094-3 DOOR CLOSER INSTRUCTION SHEET

GreenGuard
BY KASON INDUSTRIES



7/8
[22, 3]

1. WITH DOOR CLOSED, MATCH THE MOUNTING TEMPLATE DOOR LINE WITH UPPER DOOR EDGE.
2. CENTER PUNCH VERTICALLY SLOTTED HOLES WHERE INDICATED WITH A +.
3. DRILL CENTER PUNCHED HOLES FOR SCREWS.
4. WITH DOOR OPEN, MOUNT DOOR CLOSER AND HOOK USING SCREWS.
5. ACTIVATE LEVEL ARM OF DOOR CLOSER BY PULLING ARM INTO DOWN POSITION AS SHOWN IN FIG "A".
6. CLOSE DOOR SLOWLY, ROLLER SHOULD JUST CLEAR THE HOOKS OUTER LIP AS SHOWN IN FIG "A".
7. WHEN PROPERLY ADJUSTED, PUNCH AND DRILL REMAINING HOLE(S), THEN FASTEN BOTH SECURELY.

FIGURE "A"

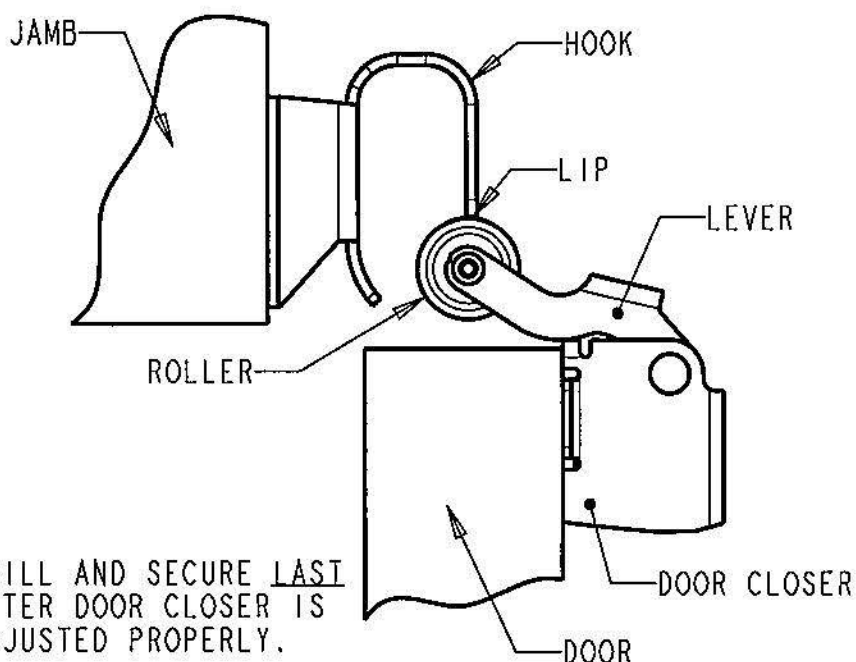

DRILL AND SECURE LAST
AFTER DOOR CLOSER IS
ADJUSTED PROPERLY.



WARNING

This item may contain chemicals known to cause cancer or reproductive harm in the State of California. www.P65Warnings.ca.gov

IS-1094 REV 06 4-15-16