



BEVERAGE-AIR

Project: _____	AIA# _____
Item: _____	
Location: _____	SIS# _____
Approved: _____	

CF MERCHANDISER SERIES

CF3HC Countertop Freezer
Hydrocarbon Series

MODELS:
CF3HC-1-W



CF3HC-1-W

1 Year Parts/Labor Warranty
Additional 4 Year Compressor Part Only

CABINET CONSTRUCTION

- White powder coated paint steel exterior
- Interior white painted steel for easy cleaning
- Triple pane glass
- 2 Shelves standard, adjustable one full and one half shelf
- Unit standard with leveling legs which are 2" high, legs can be adjusted up to 1" for leveling of the freezer
- LED lighting standard
- Freezer operating temperature is -10°F-0°F

OPTIONS & ACCESSORIES

- ☐ Custom Graphics

REFRIGERATION SYSTEM

- Refrigeration system uses R290 refrigerant to comply with all
- Cold wall evaporator
- The unit is best suited for an environment where temperatures remain below 75°F and humidity does not exceed 55%.

CF3HC Countertop Freezer: Merchandiser Series



3779 Champion Blvd., Winston-Salem, NC 27105
1-888-845-9800 Fax: 1-336-245-6453
Beverage-Air.com sales@bevair.com



BEVERAGE-AIR

Countertop Freezer

Models: CF3HC-1-W

MODEL	CF3HC-1-W
EXTERNAL DIMENSIONAL	
Width Overall	23.7"
Depth Overall	23.9"
Height Overall <i>Height excludes leveling legs</i>	29.2"
Number of Doors	1
INTERNAL DIMENSIONAL	
NET Capacity (cubic ft.)	2.9
Number of Shelves	2
ELECTRICAL DATA	
Full Load Amperes 115/60/1	4
REFRIGERATION DATA	
Horsepower	1/4
WEIGHT DATA	
Gross Weight (Crated lbs)	120 lbs
Height - Crated	33"
Width - Crated	26"
Depth - Crated	26"

Model Views

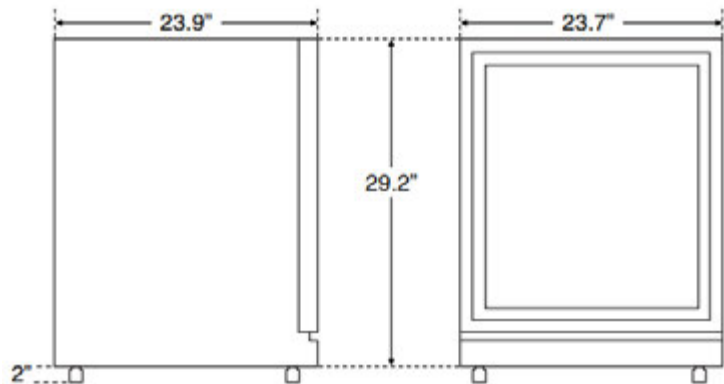

Plan View

ELECTRICAL CONNECTION



NEMA-5-15P

Units pre-wired at factory and include cord and plug set.



an Ali Group Company



The Spirit of Excellence

3779 Champion Blvd., Winston-Salem, NC 27105
1-888-845-9800 Fax: 1-336-245-6453
Beverage-Air.com sales@bevair.com