



# BEVERAGE-AIR®

|                 |            |
|-----------------|------------|
| Project: _____  | AIA# _____ |
| Item: _____     |            |
| Location: _____ | SIS# _____ |
| Approved: _____ |            |

**DP67HC FOOD PREPARATION : DELI/PIZZA PREP SERIES**

## FOOD PREPARATION SERIES

**MODEL:**  
**DPD67HC-4**

**DPD67HC Deli/Pizza Prep Table with Four Drawers**  
**Hydrocarbon Series**



**3 Year Parts/Labor Warranty**  
**Additional 4 Year Compressor Warranty**

### CABINET CONSTRUCTION

- Stainless steel front, sides, top, drawers and grille (galvanized back & bottom)
- Interior liner is made of corrosion resistant aluminum
- Aluminum top interior liner prevents spill from falling into cabinet
- Stainless steel top
- Removable hoods and insulated lid assemblies are made of matching stainless steel
- Magnetic gaskets provide positive seal on drawers
- 3" Casters, 2 with brakes standard
- 19" Wide reversible cutting board is removable for easy cleaning
- Units will accept pans up to 6" deep (pans are not included)
- Drawer frames are heavy-duty stainless steel
- 12-Gauge stainless steel drawer slides with Delrin® rollers rated at 275 lbs
- Telescoping slides, with locking mechanism to prevent drawers from being pulled off of cabinet
- Heavy-duty pan locking divider supports are standard in drawers

### OPTIONS & ACCESSORIES

- Stainless steel back and grille
- Stainless steel interior
- Clear-lid models
- Combination door/drawer models
- Composite cutting board
- Night cover
- 6" Casters
- 6" Legs black or seismic/flanged
- Remote option\* (see note on back page)

### REFRIGERATION SYSTEM

- Uses environmentally friendly, energy efficient R290 refrigerant, and meets all regulatory requirements for CARB, SNAP, DOE & more
- Adaptive defrost
- Epoxy coated evaporator coil
- Raised rail maintains temperatures between 36° - 38°F



  
Please verify qualifying units by visiting:  
[www.energystar.gov/cfs](http://www.energystar.gov/cfs)

3779 Champion Blvd., Winston-Salem, NC 27105  
1-888-845-9800 Fax: 1-336-245-6453  
Beverage-Air.com Sales@bevair.com



# BEVERAGE-AIR®

| MODEL                            | DPD67HC-4         |
|----------------------------------|-------------------|
| <b>EXTERNAL DIMENSIONAL DATA</b> |                   |
| Width Overall                    | 67"               |
| Depth Overall                    | 37"               |
| Height Overall with Casters      | 53 1/8"           |
| Number Drawers                   | 4                 |
| Depth with Drawer Extended       | 56 1/8"           |
| Drawer Opening                   | 21 5/8" x 10 5/8" |
| <b>INTERNAL DIMENSIONAL DATA</b> |                   |
| NET Capacity (cubic ft.)         | 20.7              |
| Internal Width Overall (in)      | 48"               |
| Internal Depth Overall (in)      | 26"               |
| Internal Height Usable (in)      | 23 3/4"           |
| <b>ELECTRICAL DATA</b>           |                   |
| Full Load Amperes                | 4.5               |
| <b>REFRIGERATION DATA</b>        |                   |
| Horsepower                       | 1/2               |
| Capacity (BTU/Hr)                | 2940              |
| <b>SHIPPING DATA</b>             |                   |
| Gross Weight - Crated            | 484 lbs           |
| Height - Crated                  | 47 1/2"           |
| Width - Crated                   | 70"               |
| Depth - Crated                   | 37"               |

\*NOTE: Remote units are field wired and come with 6" legs.  
Refrigerant must be specified at time of order.



Top Configuration



Drawer Configuration

## Deli/Pizza Preparation Table

Models: DPD67HC-4

### Model Views

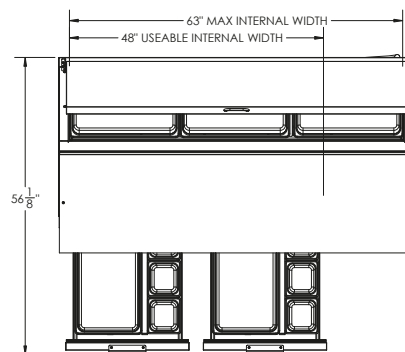

### PLAN VIEW

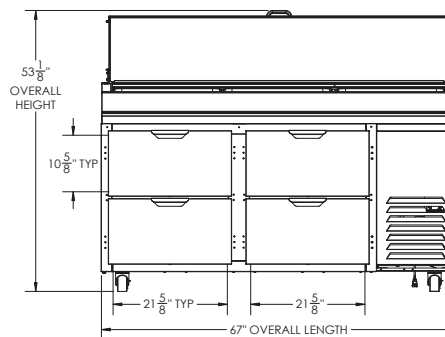

### ELEVATION VIEW

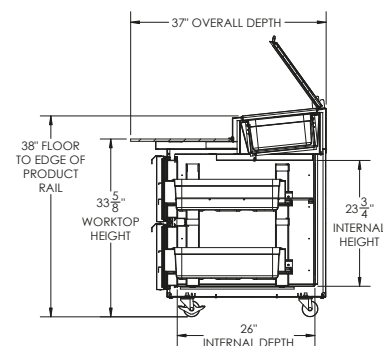

### SIDE VIEW

### \*ELECTRICAL CONNECTION



115/60/1  
NEMA 5-15P

Units pre-wired at  
factory and include 8'  
long cord and plug set.



3779 Champion Blvd., Winston-Salem, NC 27105 1-888-845-9800 Fax: 1-336-245-6453 Beverage-Air.com Sales@bevair.com

an Ali Group Company



The Spirit of Excellence