



# BEVERAGE-AIR®

Project: \_\_\_\_\_  
Item: \_\_\_\_\_  
Location: \_\_\_\_\_  
Approved: \_\_\_\_\_

AIA#

SIS#

## NC SLANT TOP BUNKERS

NC28HC Novelty Freezers  
Hydrocarbon Series

MODEL:  
NC28HC-1-W

NC28HC NOVELTY FREEZER: SLANT TOP BUNKERS



**3 Year Parts/Labor Warranty**  
**Additional 4 Year Compressor Warranty**

### CABINET CONSTRUCTION

- Exterior is white coated steel
- Interior is white painted steel surface
- Low energy consumption
- LED lighting
- Adjustable thermostat
- Operating temperature of -10°F to 0°F
- Angle top design with LowE tempered glass lids
- Lids are easily removable with lid lock & keys standard
- Round exterior edges
- Integrated tag molding
- 2" heavy duty casters
- Drain plug for easy cleaning
- 2 Removable baskets, standard

### OPTIONS & ACCESSORIES

- 2 Ring tub holder

### REFRIGERATION SYSTEM

- Refrigeration system uses R290 refrigerant to comply with all environmental concerns
- The unit is best suited for an environment where temperatures remain below 75°F and humidity does not exceed 55%
- Areas with direct sunlight should also be avoided
- Maintenance free condenser



  
Please verify qualifying units by visiting:  
[www.energystar.gov/cfs](http://www.energystar.gov/cfs)

3779 Champion Blvd., Winston-Salem, NC 27105  
1-888-845-9800 Fax: 1-336-245-6453  
Beverage-Air.com Sales@bevair.com



# BEVERAGE-AIR

MODEL	NC28HC-1-W
<b>EXTERNAL DIMENSIONAL DATA</b>	
Width Overall	27 <sup>7</sup> / <sub>8</sub> "
Depth Overall	26 <sup>3</sup> / <sub>8</sub> "
Height Overall (with casters)	36 <sup>7</sup> / <sub>8</sub> "
Number of Lids	2
Number of Baskets	2
<b>INTERNAL DIMENSIONAL DATA</b>	
NET Capacity (cubic ft.)	6.02
Internal Width Overall (in)	21 <sup>1</sup> / <sub>16</sub> "
Internal Depth Overall (in)	19 <sup>1</sup> / <sub>16</sub> "
Internal Front Height Overall (in)	23 <sup>3</sup> / <sub>16</sub> "
Internal Rear Height Overall (in)	21 <sup>1</sup> / <sub>16</sub> "
<b>ELECTRICAL DATA</b>	
Full Load Amperes	3.0
<b>REFRIGERATION DATA</b>	
Horsepower*	1/5
<b>SHIPPING DATA</b>	
Gross Weight - Crated	144 lbs
Height - Crated	35 <sup>3</sup> / <sub>16</sub> "
Width - Crated	29 <sup>3</sup> / <sub>8</sub> "
Depth - Crated	27 <sup>7</sup> / <sub>16</sub> "

## Slant Top Bunker

Model: NC28HC-1-W

### Model Views

Requires 3" clearance on all sides

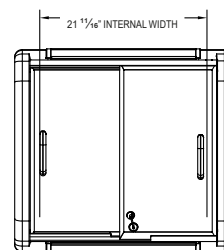

### PLAN VIEW

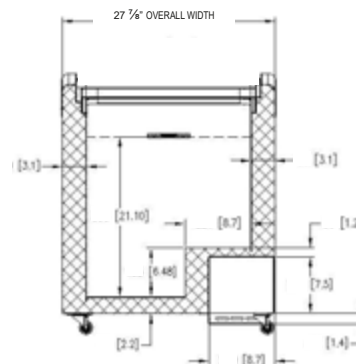

### ELEVATION VIEW

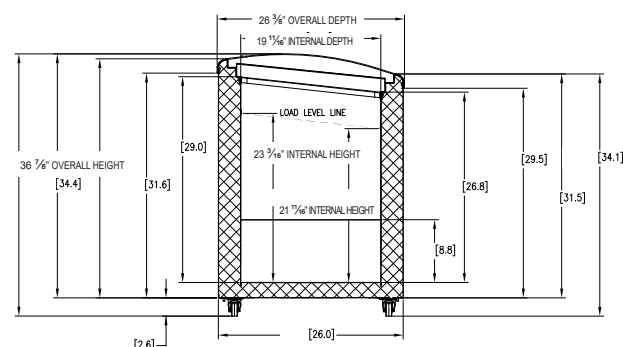

### SIDE VIEW

### \*ELECTRICAL CONNECTION



Units pre-wired at factory and include 8' long cord and plug set.



3779 Champion Blvd., Winston-Salem, NC 27105 1-888-845-9800 Fax: 1-336-245-6453 Beverage-Air.com Sales@bevair.com

an Ali Group Company



The Spirit of Excellence