



BEVERAGE-AIR

| | |
|-----------------|------------|
| Project: _____ | AIA# _____ |
| Item: _____ | |
| Location: _____ | SIS# _____ |
| Approved: _____ | |

UCRD UNDERCOUNTER REFRIGERATOR

UCRD60AHC Door & Drawer Combination

Hydrocarbon Series

MODELS:
UCRD60AHC-2



UCRD60AHC-2

3 Year Parts/Labor Warranty
Additional 2 Year Compressor Warranty

CABINET CONSTRUCTION

- Stainless steel front, sides, top, door and drawers, (*galvanized back & bottom*)
- Interior liner is made of corrosion resistant aluminum
- Full electronic control
- Interior thermometer is standard
- Durable sub-top 1/2" insulated for added durability
- Self-closing doors with 120° Stay-open feature, on cartridge style hinges
- Easy door removal for service and cleaning
- Magnetic gasket attached to each door and drawer for positive seal
- Painted aluminum door and drawer handles
- 6" Casters, 2 with brakes standard
- Two (2) epoxy-coated steel wire shelves
- Stainless steel drawer frames supported on telescoping drawer slides
- Drawer slides include locking mechanism that prevents drawers from being inadvertently pulled off cabinet
- Maintains product temperature between 36°F and 38°F

OPTIONS & ACCESSORIES

- ☐ Stainless steel back and grille
- ☐ Stainless steel interior
- ☐ Right or left hinged door
- ☐ Bun rack
- ☐ Locks (solid doors only)
- ☐ Wire shelf divider
- ☐ 3" Casters or 6" legs
- ☐ Low profile casters
- ☐ Remote option

REFRIGERATION SYSTEM

- Refrigeration system uses R290 refrigerant to comply with all environmental concerns
- Automatic, non-electric defrost
- Epoxy coated evaporator coil

UCRD60AHC-2 Undercounter Refrigerator: Food Prep Series



3779 Champion Blvd., Winston-Salem, NC 27105
1-888-845-9800 Fax: 1-336-245-6453
Beverage-Air.com sales@bevair.com



BEVERAGE-AIR

| MODEL | UCRD60AHC-2 |
|----------------------------------|---------------------|
| EXTERNAL DIMENSIONAL DATA | |
| Width Overall | 60" |
| Depth Overall | 32" |
| Height Overall with 6" Casters | 34 5/8" |
| Number of Doors | 1 |
| Depth with Doors Open Extended | 55 1/4" |
| Number of Drawers | 2 |
| Drawers Opening (in) | (2) 22 5/8 X 9 3/8" |
| INTERNAL DIMENSIONAL DATA | |
| NET Capacity (cubic ft.) | 14.4 |
| Internal Width Overall (in) | 56" |
| Internal Depth Overall (in) | 23 1/2" |
| Internal Depth Useable (in) | 15 3/8" |
| Internal Height Overall (in) | 23" |
| ELECTRICAL DATA | |
| Full Load Amperes 115/60/1 | 3.0 |
| REFRIGERATION DATA | |
| Horsepower | 1/5 |
| Capacity (BTU/Hr)* | 1350 |
| WEIGHT DATA | |
| Gross Weight (Crated lbs) | 320 lbs |
| Height - Crated | 36" |
| Width - Crated | 63" |
| Depth - Crated | 33" |

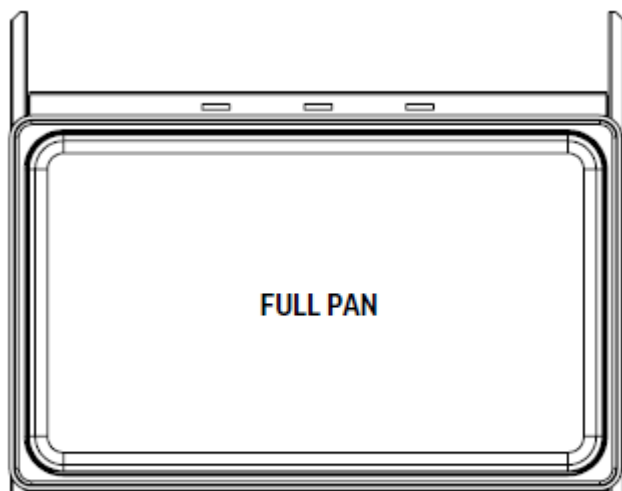

UCRD27 / UCRD32 / UCRD60
UCFD27 / UCFD32 / UCFD60



Undercounter Refrigerators Door & Drawer Combination Models: UCRD60AHC-2

Model Views

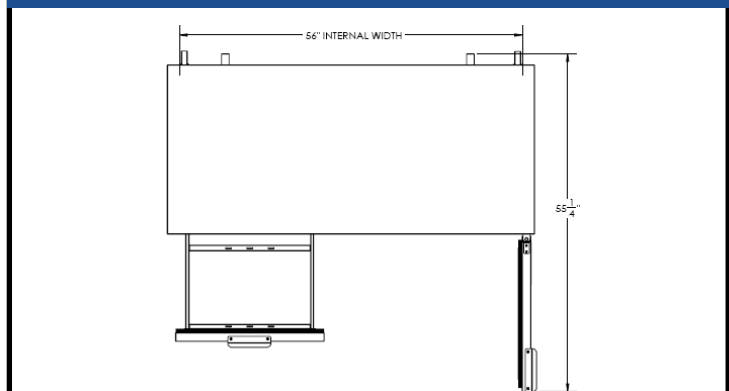

Plan View

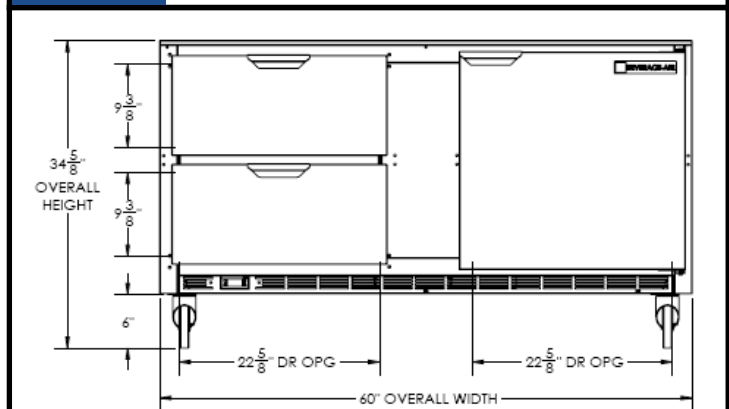

Elevation View

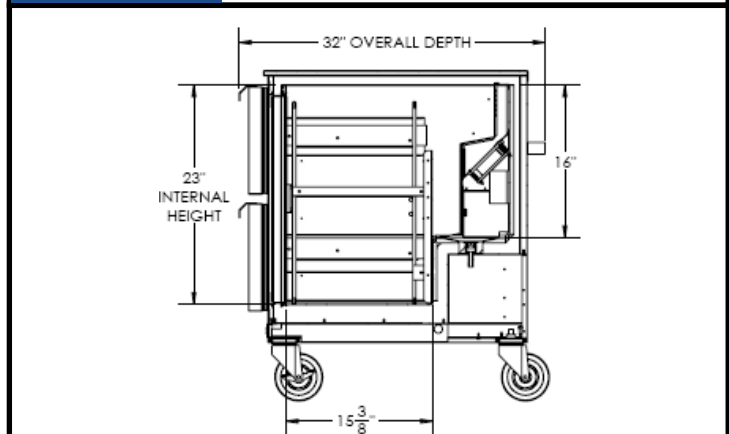

Side View

ELECTRICAL CONNECTION



115/60/1
NEMA-5-15P

Units pre-wired at factory
and include 8' long cord
and plug set.



an Ali Group Company



3779 Champion Blvd., Winston-Salem, NC 27105
1-888-845-9800 Fax: 1-336-245-6453
Beverage-Air.com sales@bevair.com