



Field Reversible Door Instructions

FOR 17 CU. FT. REACH-INS

• EDRR-17-B-HC • EDRF-17-B-HC

Tools Needed:

- Phillips Head screwdriver.
- 10mm Wrench.

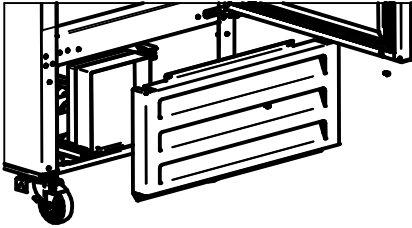

1.- Use the phillips head screwdriver remove the front panel screws, next remove the front panel.

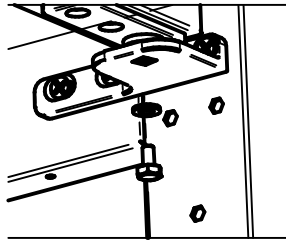

2.- Use the Wrench to remove the bottom hinge hex screw, then loosen the hinge screw and carefully remove the door.

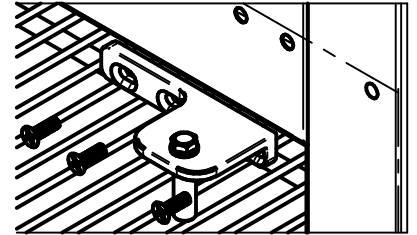

3.- Use the scredriver to remove the bottom and top hinges.

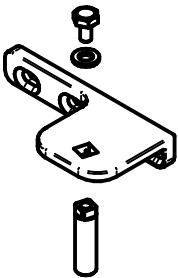

4.- With help of a spanner key 10mm, remove the bolt of top hinge, next install the bolt in to bottom hinge.

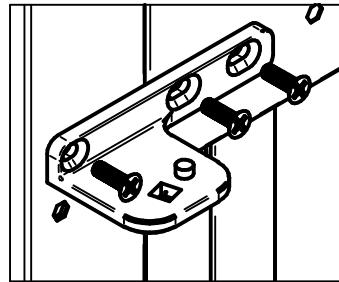

5.- Install the Bottom right hinge in the top left side of the equipment. Then, install the top right hinge in the bottom left side of the equipment.

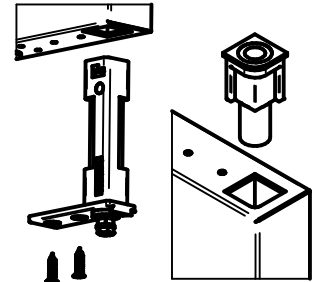

6.-Remove the bottom cartridge and bolt housing from the door, install the cartridge at the top of the door and the bolt housing in the bottom side

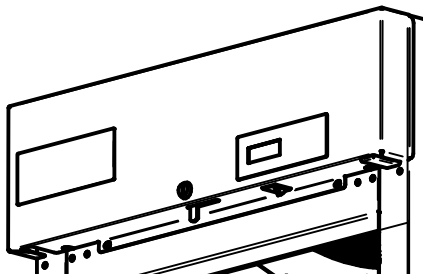

7.- Remove the top head screws, then remove the hinge cap to the right side. Reinstall the top head screws.

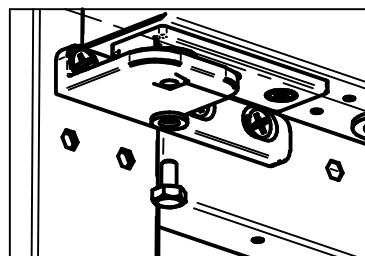

8.-Install the hinges on the left side, but do not tighten the screws. Then install the door and install the cartridge screw. Tighten all screws.

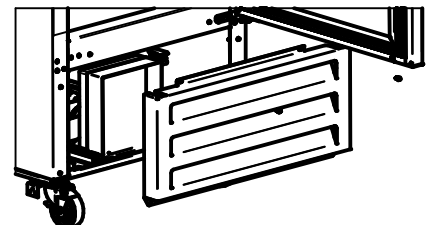

9.-Reinstall the Front panel with the Hinge cap on the right side.