

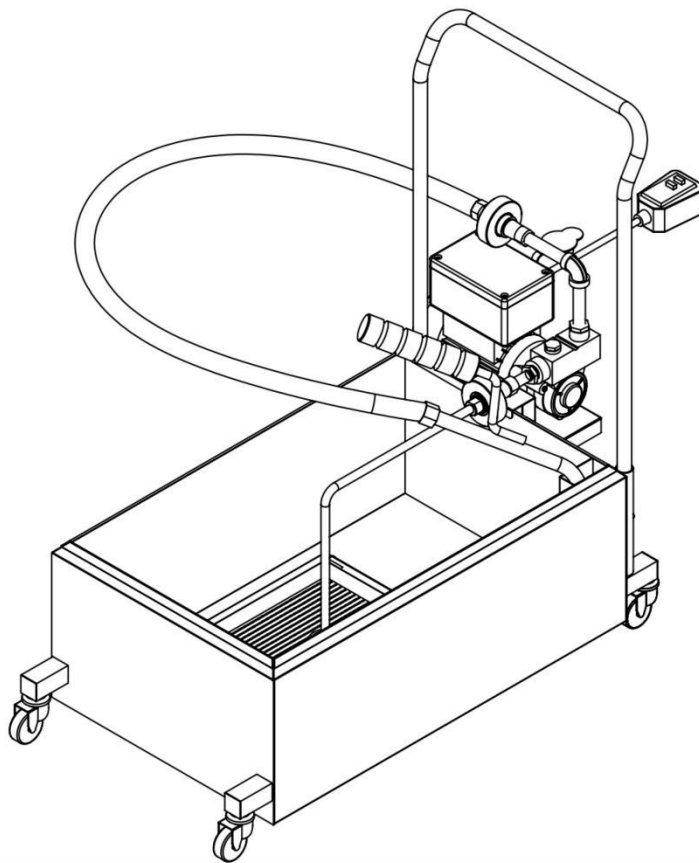

Oil Fliter Operation Manual



Model No.: **PA0118**

Please read and keep these instructions. Indoor use only.

IMPORTANT SAFETY INFORMATION

As is the case with most equipment, your oil filter should be used with caution. Please read the following warnings to avoid potential injuries.

- 1、 Because this equipment utilizes high voltage, it should only be serviced by a licensed electrician or trained servicer. Attempting to service the equipment yourself could result in serious, potentially fatal injuries.
- 2、 If an electrical shock is felt when touching equipment, shut off power immediately (unplug cord or turn off circuit breaker) and call a trained servicer for repair. Failure to do so could result in serious, potentially fatal injuries.
- 3、 Always turn power switch off any time the equipment is not in use.
- 4、 **CAUTION** : This equipment is not intended for use by persons with reduced physical, sensory, or mental capabilities, or lack of experience and knowledge, unless they have been given supervision or instruction concerning use of the equipment by a person responsible for their safety.
- 5、 **CAUTION** : Children should be supervised to ensure that they do not play with the equipment.
- 6、 **CAUTION** : This equipment is intended to be used for commercial applications, for example in kitchens of restaurants, canteens, hospitals and in commercial enterprises such as bakeries
- 7、 **CAUTION** : These models are designed, built, and sold for commercial use only.
Make sure that cautions, warnings, and operating instructions are clearly posted near each unit so that anyone using the equipment will use it correctly and not injure themselves or harm the equipment.
- 8、 DO NOT USE if the filter tank is not completely dry and free of water droplets.
- 9、 DO NOT overfill the filter tank. The maximum capacity is **95** lb. of oil.
- 10、 DO NOT use water jets to clean this equipment. Doing so will damage the unit and void the warranty.
- 11、 DO NOT use the electrical cord as a leash to move the appliance.
- 12、 DO NOT attempt to move this appliance or transfer hot liquids from one container to another when the unit is at operating temperature or filled with hot liquids.
- 13、 DO NOT leave appliance unattended while draining or refilling with oil/shortening.
- 14、 The power supply must be disconnected before servicing, maintaining, or cleaning this machine.
- 15、 DO NOT pump water through the filter pump system. The pump functions using the lubrication of oil and using water will damage the pump.
- 16、 DO NOT attempt to lift filter machine off floor for cleaning. Bodily injury may occur. 1
- 17、 DO NOT use the appliance as a step for cleaning or accessing the ventilation hood. Serious injury could result from slips, trips, or contact with hot oil.
- 18、 If the supplied power cord or receptacle is damaged, it **MUST** be replaced by an authorized service and parts company technician in order to avoid a hazard.

NOTE: Save these instructions for future reference.

IDENTIFICATION OF KEY PARTS

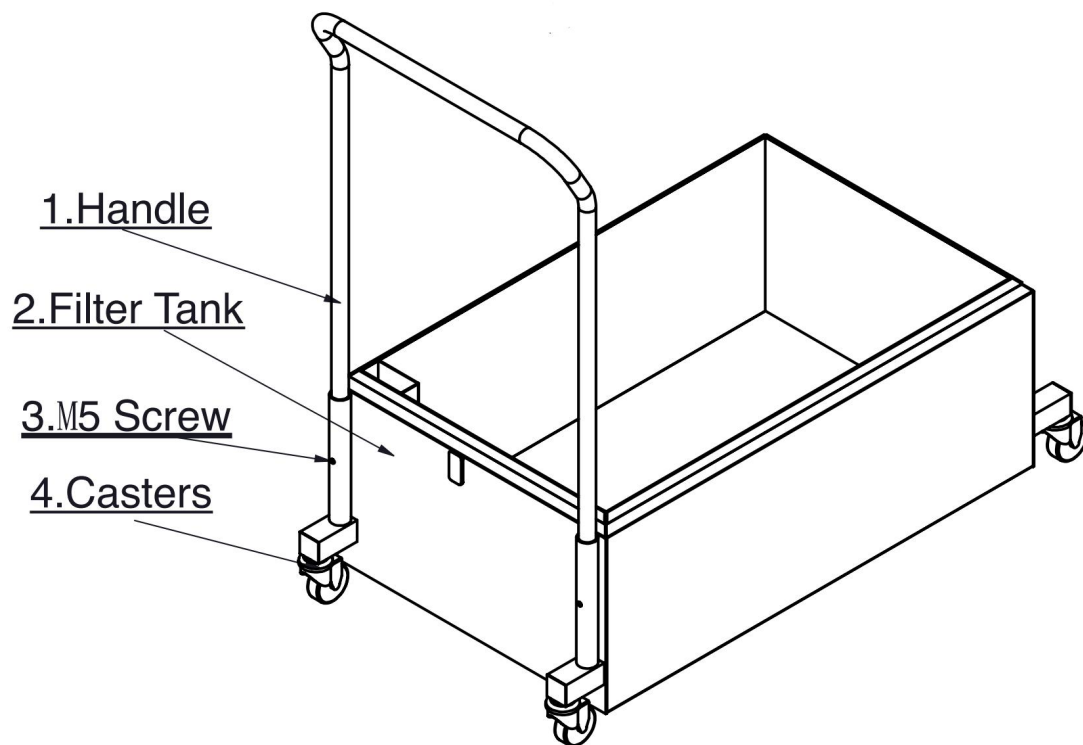
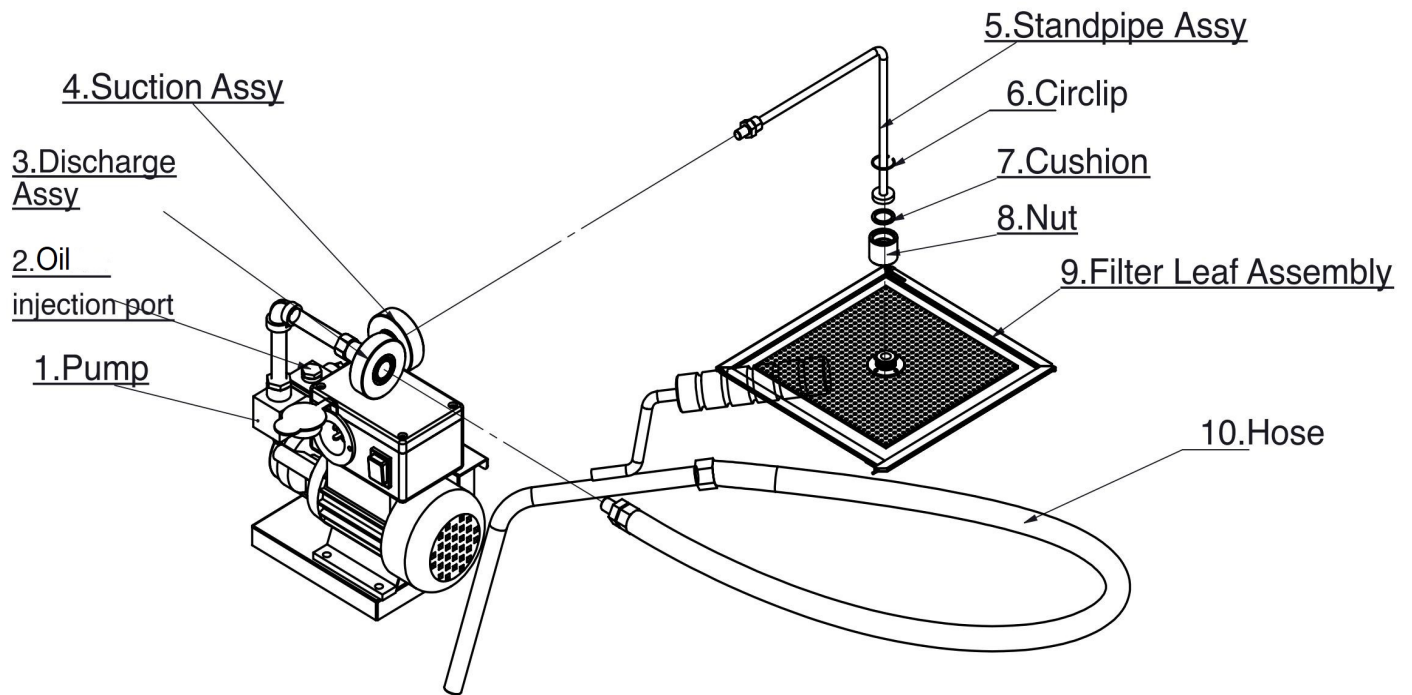

SPECIFICATION

| Model No. | Voltage/Power | Product Size | Package Size |
|-----------|---------------|------------------------|-------------------------|
| PA0118 | 115V/250W | 17"W x 36.6"D x 17.7"H | 19.7"W x 38.58"D x 14"H |

INSTALLATION

After removing the outer shipping carton and packaging material, place the machine on the floor or other flat surface.

1. Attach the casters to the filter tank and tighten
2. Insert the handle to the filter tank
3. Screw the standpipe assembly onto the filter leaf assembly.
4. Insert the standpipe quick disconnect nipple into the quick disconnect coupling on the pump.
5. Insert the quick disconnect nipple on the end of the hose and nozzle assembly into the quick disconnect coupling on the discharge assembly.
6. Open fryer drain and drain the frying oil into the oil filter

REMARK: In order to ensure that the vacuum inside the oil pump operates correctly, add 3.5 oz. of oil to the oil injection port before the first time operating. This step should be repeated each time the oil pump is cleaned.

NOTE: The oil pump needs to be cleaned after every use, there is no need to refit without cleaning.

(The purpose of injecting oil is to create a vacuum inside the oil pump to drive self-suction)

CLEANING

1. Disconnect filter hose wand and drain.
2. Disconnect filter tube and turn pump on for 3-5 seconds to force shortening from pump. Failure to do this will cause pump or hose to clog with shortening.
3. Unplug shortening filter.
4. Remove filter tube and clamp assembly.
5. Unscrew wing nuts on filter clamp assembly to remove filter plate.
6. Wash filter plate and thoroughly rinse with hot water and dry well.
7. Remove and wash tank. Rinse and dry thoroughly.
8. Replace tank onto filter.
9. Wash clamp assembly, rinse with hot water, and dry well.
10. Replace filter plate on tube and clamp assembly and install in tank.