



Project Name:	
Location:	
Item:	Qty:
Model:	

COMMERCIAL CHEST FREEZERS

Models : BCF-155, BCF-205, BCF-450



Model : BC-155



Model : BCF-205 / BCF-450

BERG's chest freezers are designed for both commercial and household use. This unit features a lockable lid to ensure the security of stored items. The low-profile casters facilitate easy mobility, making it simple to move the freezer as needed. Constructed with a durable white powder-coated steel exterior and an embossed aluminum interior, this chest freezer is built to last. It operates with a manual temperature controller that includes light-up indicators for easy monitoring. These models are ETL Listed and ETL Sanitation Listed. They come with a NEMA 5-15 plug and a six foot cord that requires a grounded circuit for safe operation.

Product Features



- Maintains a temperature range of -18° to 23°F
 - Heavy duty white powder-coated steel exterior
 - Embossed aluminum interior
 - R290 refrigerant ensures ideal operating temperatures
 - Includes two baskets
 - Casters for easy moving and cleaning
 - Foamed-in-place polyurethane high density cell insulation throughout the entire cabinet
- (Model : BCF-155 does not have a lock)

Operating Conditions

- Minimum distance of at least 4" is required along the sides and back of the chest freezer.

Warranty

- One year limited replacement warranty

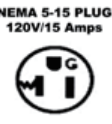
   	Specifications subject to change without notice.
	For warranty service on these products, please call BERG at 888-585-9440



Project Name:	
Location:	
Item:	Qty:
Model:	

COMMERCIAL CHEST FREEZERS Models : BCF-155, BCF-205, BCF-450

DIMENSIONS

BCF-155

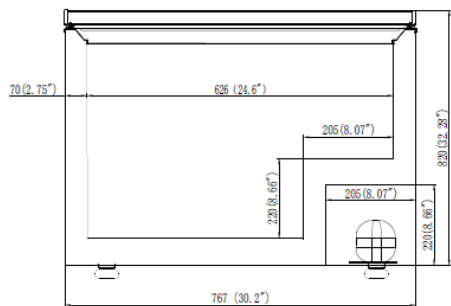

BCF-205

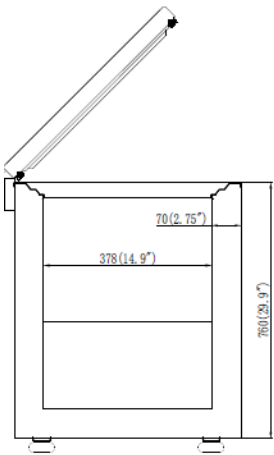
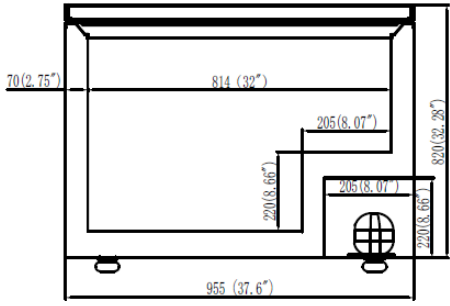

SIDE VIEW

BCF-450

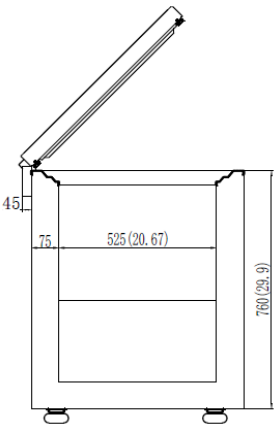
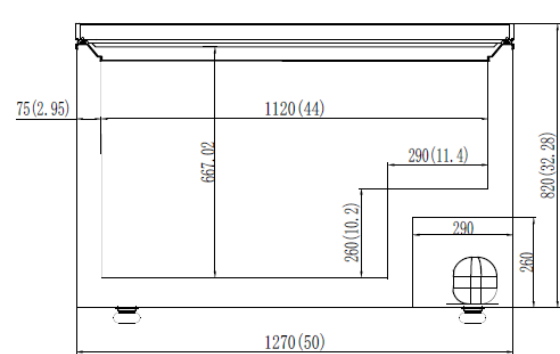

SIDE VIEW

Model Number	BCF-155	BCF-205	BCF-450
Net Volume Cu. Ft.	5.2 Cu. Ft.	7 Cu. Ft.	12.7 Cu. Ft.
Overall Dimensions (in)	30.2" x 20.67" x 29.9"	37.6" x 20.67 "x 29.9"	50" x 26.77" x 29.9"
Interior Dimensions (in)	24.6" x 14.9" x 26.25"	32" x 14.9" x 26.25"	44" x 20.67" x 26.25"
Voltage/Hertz	115V/60Hz	115V/60Hz	115V/60Hz
Refrigerant	R290	R290	R290
Gross Weight (lbs)	79	93	134